

**Zylinderstifte**

Toleranz m6

**Goupilles cylindriques**

tolérance m6

aus Stahl min. 600 N/mm<sup>2</sup>, gehärtet

HRc 60 ±2

**blank, geschliffen**en acier 600 N/mm<sup>2</sup> min., trempé

HRc 60 ±2

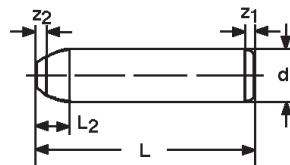
**clair, rectifié**

~ISO 8734 A

~ISO 8734 A

d -m6	1,5		2		3		4		5		6	
L 2	0,5		0,6		0,8		1		1,2		1,5	
z 1~	0,23		0,3		0,45		0,6		0,75		0,9	
z 2~	0,12		0,18		0,3		0,4		0,5		0,6	
L	100	500	100	500	100	500	100	500	100	500	100	500
5	17.—	12.20	19.20	13.90	20.40	14.70						
6	17.90	13.—	19.20	13.90	20.40	14.70	19.10	17.40				
8	17.90	13.—	19.50	14.10	19.80	14.40	20.40	18.40	26.10	23.70	38.60	34.40
10	18.70	13.80	19.80	14.40	19.80	14.40	20.40	18.40	26.10	23.70	38.60	34.40
12			20.10	14.60	20.10	14.60	21.40	19.30	26.90	24.10	34.90	31.20
14			20.10	14.60	21.50	15.60	22.10	20.—	28.50	25.60	36.40	32.80
16			20.50	14.90	20.80	14.90	22.90	20.70	29.—	26.10	38.60	34.80
18			21.20	15.40	21.50	15.60	25.40	22.90	33.40	30.30	39.50	35.30
20			21.20	15.40	21.90	15.90	26.30	23.80	32.70	29.30	39.50	34.90
22					24.—	19.20	29.—	26.10	37.—	32.90	44.40	39.80
24			26.80	19.30	24.60	19.70	29.—	26.10	35.70	32.10	41.60	37.60
26					30.50	22.10	34.90	31.60	40.10	36.—	44.40	39.80
28			34.20	24.70	31.30	22.50	34.90	31.60	40.10	36.—	44.40	39.80
30					32.40	22.80	36.40	32.50	39.50	34.90	47.60	42.30
32					33.—	23.30	44.40	39.80	43.90	39.—	51.30	46.—
36					34.20	26.10	49.—	43.80	50.50	45.30	59.—	52.40
40					39.40	28.70	49.70	44.50	49.70	44.50	61.—	55.—
45							53.40	47.90	51.90	46.70	67.—	60.50
50					67.—	51.90	50.50	45.30	54.50	48.40	70.—	62.50
55											74.50	67.—
60							94.—	85.—	67.50	61.—	81.—	73.—
70											96.50	87.—
80									142.—	128.—	112.—	100.—
90											146.—	134.—
		100	100	100	100	100	100	100	100	100	100	100